



# DALLAS COUNTY UNINCORPORATED AREAS

✉ Development@dallascounty.org

☎ (214)653-6565

🌐 [www.dallascounty.org/departments/duas/](http://www.dallascounty.org/departments/duas/)



## DEVELOPMENT PERMIT FEES

## AMOUNT

Development Permit Level 1	\$35.00
Development Permit Level 2 & 3	\$100.00
Development Permit Level 4	\$250.00

## PLATTING FEES

## AMOUNT

1 - 5 Lots	\$150.00 + \$25.00 per lot
6 - 20 Lots	\$400.00 + \$25.00 per lot
21 + Lots	\$635.00 + \$25.00 per lot
5 acres or less	\$115.00 + \$20.00 per lot
5 + acres	\$250.00 + \$20.00 per lot

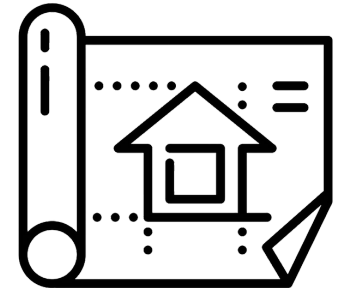

## OTHER PERMIT FEES

## AMOUNT

Cell Tower Communications Facilities	\$50.00
Driveway / Culvert	\$75.00
Mobile Home / RV Placement	\$50.00
Notice of Residential	\$50.00
Pre-Development Meeting	\$35.00
Residential Building Permit	\$100.00
Right of Way / Utility	\$75.00
Slaughterhouse Permit	\$500.00



### NOTES:

- \* Does not include any associated County Clerk fees if a document requires filing.
- \* Commercial building and operations are associated with the Fire Marshall Fees Schedule
- \* Septic Fees are associated with Health & Human Services Environmental Health Fees Schedule

**Last update: 8/30/2023**